



OWNERS INSTRUCTION MANUAL

102cm/40"

Stellar

- INSTALLATION
- OPERATION
- MAINTENANCE

CAUTION

READ INSTRUCTIONS CAREFULLY FOR SAFE
INSTALLATION AND FAN OPERATION. IF UNSURE CONSULT
A QUALIFIED ELECTRICIAN

SUITABLE FOR 230V/50 CYCLE ELECTRICAL SUPPLY
Enquiries on installing your fan please call our help line on

01959-564440

E-mail : technical@fantasiaceilingfans.com

Safety Precautions

1. To ensure the success of the installation be sure to read the instructions and study the diagrams thoroughly before commencing.
2. All electrical work should only be undertaken after disconnection of the power by removing fuses or turning off the circuit breaker to ensure all pole isolation of the electrical supply. If you are in any doubt the services of a qualified electrician should be sought to ensure that all work is carried out in accordance with the I.E.E. Regulations, current good practice and other national and local electrical codes.
3. Make sure that your installation site will not allow the rotating fan blades to come into contact with any object and that there is a minimum clearance of 150mm (6") from the blade tip to the wall or ceiling. Please note that the bigger this clearance is the better the airflow from your fan will be. Ensure the blades are mounted at a minimum height of 2.3 meters (7'6") from the floor when the fan is installed.
4. The fixing point for the fan must be able to support a weight of ten times that of the net weight of the fan. Net weights can be found on the bottom of the unit's box. If you are mounting the fan to a ceiling junction box, the box and it's fixing must be able to support the moving weight of the fan and must not twist or work loose.
5. The fan must be earthed.
6. Do not connect the fan motor to a dimmer switch. This may give an unsatisfactory performance (motor hum) and cause damage to the motor.
7. It is not recommended that ceiling fans and gas appliances are operated in the same room at the same time.
8. Do not insert anything into the fan blades while the fan is operating. This will damage the blades and upset the balance of the unit causing the unit to wobble.
9. After the fan is completely installed make sure that all connections are secure and tight to prevent any problems.
10. Because of the fan's natural movement, some connections may loosen. Check the support connections, brackets and blade attachments twice a year to make sure they are all secure. If they are loose tighten with a screwdriver. (It is not necessary to take the fan down from the ceiling)

Note : The important safeguards and instructions given in this manual are not meant to cover all possible conditions and situations that may occur. It must be understood that common sense, caution and care are factors which cannot be built into any product. These factors must be supplied by the persons caring for and using the unit.

For installation advice, or in the unlikely event of damaged or missing parts please ring:

HELPLINE : 01959 564440

Supplied Parts

- One fan DC motor,canopy,trim ring,and boss cover.
- One hanger bracket fitted with terminal block and top rubber washers.
- One 6” drop rod with hanger ball
- One set of blade (5 pcs/set)
- One screw-pack
- One installation booklet
- Remote control with preset remote receiver
- One LED single light kit & plastic shade.
- One bottom plastic cover for no light.

Tools and Materials Required

- Philips screwdriver
- Blade screwdriver
- Small electrical screwdriver
- Electrical pliers
- Step ladder
- Wiring supplies as required by current electrical practice
- Bulbs if a light fitting is fitted / to be fitted
- In-line crimps or other suitable connectors if an extension rod in excess of 450mm (18 inch) is to be fitted.

Before starting the assembly and installation of your fan please ensure the safety precautions have been read and understood.

Installation Difficulties, Missing or Damaged Parts

If you have any difficulty in installing your fan/light or if you are unfortunate enough to find that your fan has been dispatched with parts missing or damaged please contact our help-line on (01959 564440). We will be very pleased to provide help or forward replacements parts to you immediately.

In any communication with us please quote model reference, colour of the unit and the part missing or damaged.

HELPLINE
01959 564440

Parts names and their relative positions

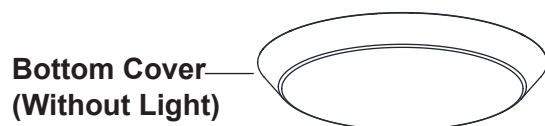
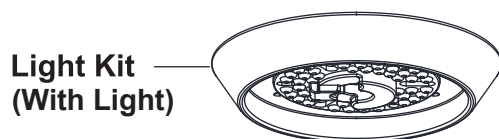
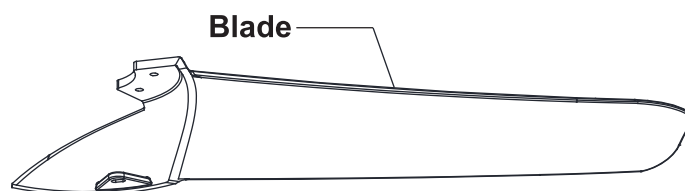
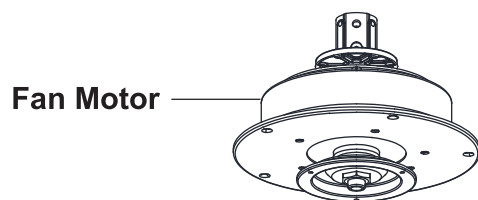
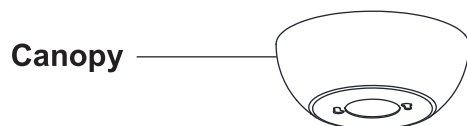

Installing the fan

All electrical work should only be undertaken after disconnection of the power by removing fuses or turning off the circuit breaker to ensure all poles isolation of the electrical supply.

Your fan is a drop rod fan (Picture A) In this situation the drop rod assembly is used to lower the fan down from it's mounting position slightly. Extension rods, ranging from 12" to 72", are available if you need to lower your fan further. (This is normally the case in conservatories or rooms with very high ceilings.)

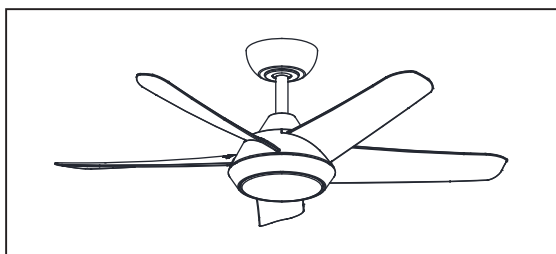

Picture A

The following steps will guide you to a successful installation

1. Hanger bracket installation
2. Assembled the blades
3. Assembled drop rod
4. Seat the ceiling fan into the Hanger Bracket
5. Remote control and Wiring instructions
6. Install the ceiling canopy and trim ring
7. Install light kit or bottom cover
8. Operating the handset(transmitter)

1. Hanger bracket installation

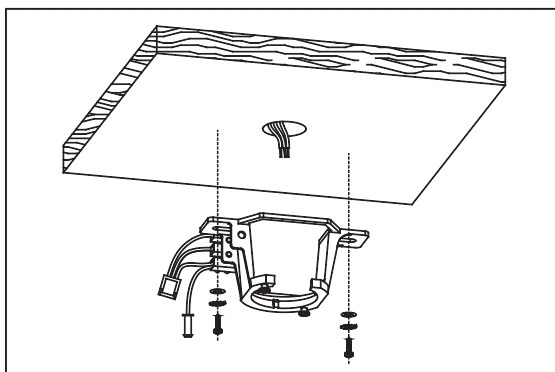

The hanger bracket should be screwed on to a firm flat surface. The fixing location must be able to withstand ten times the static weight of the fan. If you have any doubts as to the ability of your intended fixing location to be able to withstand this loading. Please contact our service help-line or another competent authority to advise you. In most situation two wood screws screwed into a wooden joist is more than adequate to support your ceiling fan. The hanger bracket should be screwed onto the joist with the two wood screws provided. The washers provided should go in the following sequence:

Screw head > spring washer > round washer>Hanger bracket > Ceiling. Screw the hanger bracket to the ceiling and make sure all connections are secure to prevent the fan from falling. Fixings must screw into a joist and not just the plasterboard. Loosen the two canopy screws from the hanger bracket.

2. Assembled blades

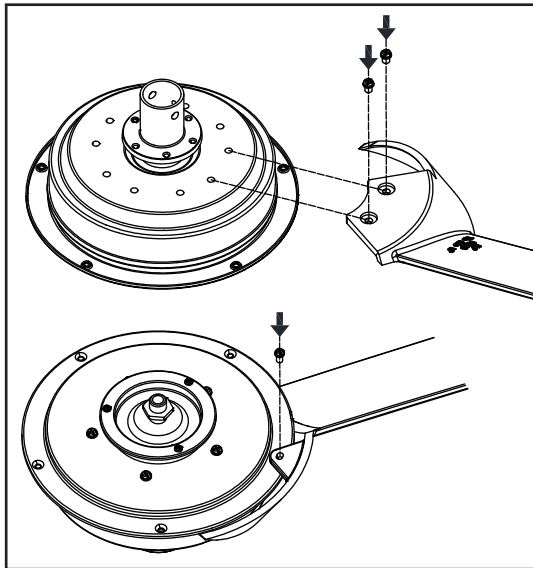

Attach the first blade to this position using the supplied blade screws. Do not screw the blade set screws too tightly at the step, just tight enough to hold the blade on motor.

Repeat to attach the other 4 blades, using the supplied blade set screws.

Adjust all blades positions until all are sit in place properly, then, secure all screws very tightly

3. Assembled drop rod

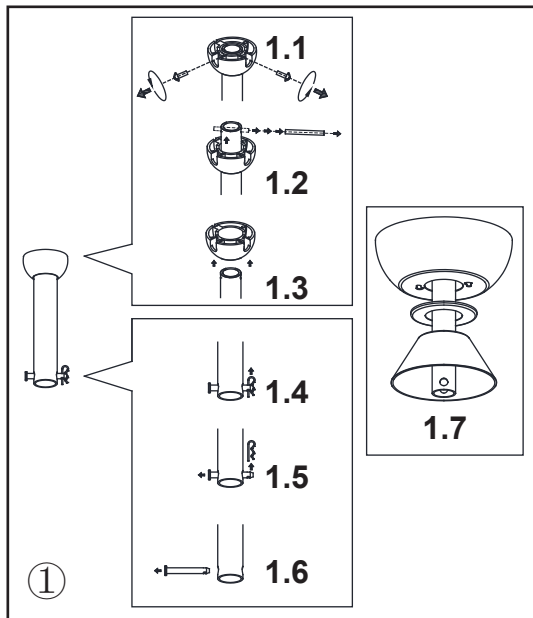

① Remove the cotter pin and clevis clip from the drop rod, and then put the drop rod through the flared end of the canopy, trim ring and boss cover before the rod is connected to the fan.

- ②Route the wires and boss cover through the drop rod and then slide the drop rod into the Downrod Coupler on top of the motor.

Install the Cotter Pin by aligning the holes in the downrod coupler with the holes in the drop rod. Secure the Cotter Pin with the Clevis Clip. Install the 2 x Screws to securely fasten the drop rod.

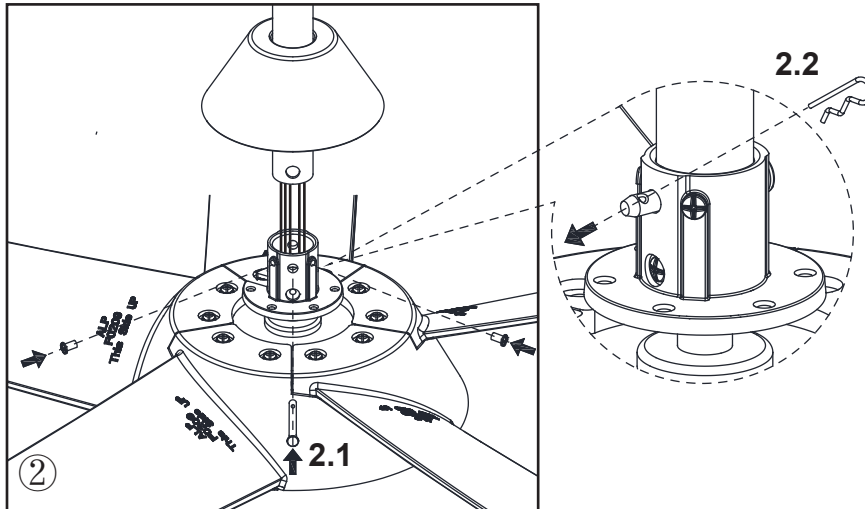

4. Put the ceiling fan into the Hanger Bracket

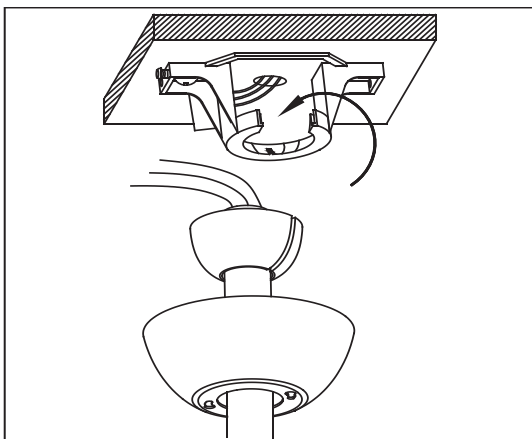

Once the blades have been fitted, lift the fan up to the hanger bracket, steer the ball in from the side of the bracket and lower it into the recess of the bracket.

Rotate the ball around until the groove in the side of the ball aligns with the protrusion on the upper edge of the recess. When aligned the fan should drop slightly as it assumes it's correct position. This is to prevent rotation of the rod and fan when the unit is working.

Connect the wiring as shown following step

5. Remote control and Wiring instructions

WIRING INSTRUCTIONS: Ensure power is safely isolated before attempting any wiring. Your fan is supplied with a radio frequency remote control unit and the fan can only be controlled by remote control. **IMPORTANT** – This appliance must be earthed.

RECOMMENDED: We suggest wiring the household supply into the Terminal Block on the hanger bracket before hanging the fan due to blades being a hindrance.

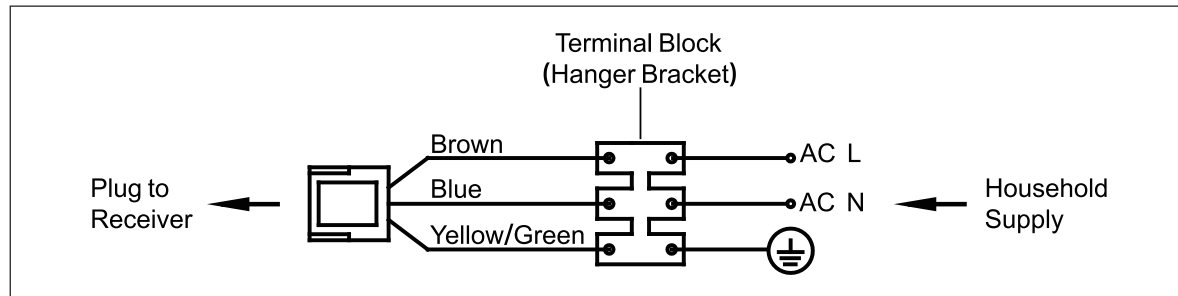

STEP 1: Connect AC Power Supply to Terminal Block

Connect the AC household power supply wires from the ceiling to the hanger bracket's terminal block. Connect the **BROWN/RED** active wire to the connection labeled "L". Connect the **BLUE/BLACK** neutral wire to the connection labeled "N".

Connect the **YELLOW/GREEN** earth wire coming from the house supply to the connection labeled with the **EARTH** symbol on the terminal block.

STEP 2 : INSERT THE REMOTE RECEIVER

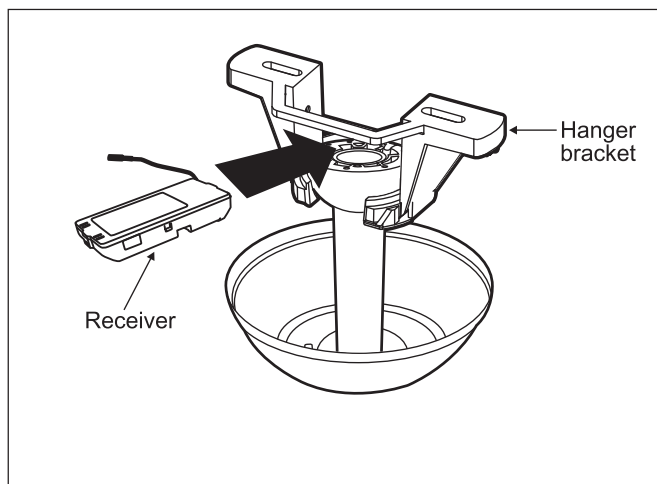

Slide the receiver unit into the hanger bracket before attempting to complete any wiring. The remote receiver unit includes wiring looms to connect to the ceiling fan and hanger bracket terminal block.

STEP 3 : Remote receiver installation and wiring

Your fan is supplied with a radio frequency remote control unit and the fan can only be controlled by remote control. **IMPORTANT** – This appliance must be earthed.

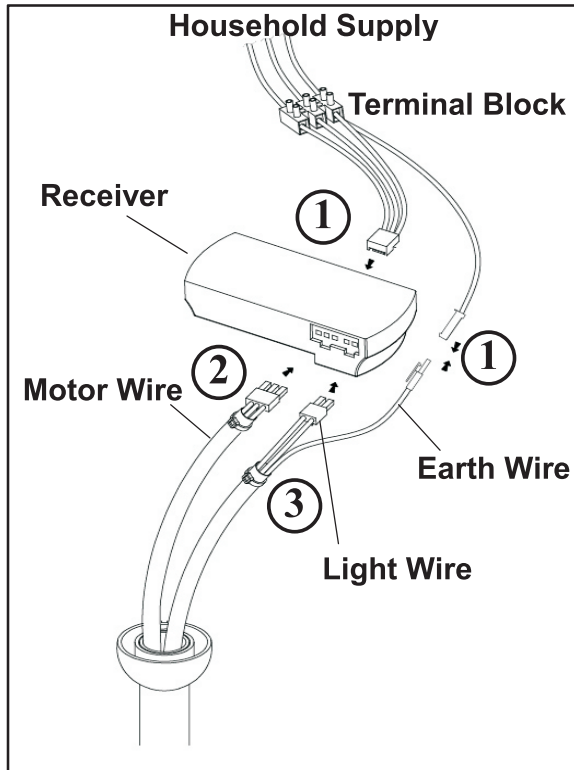

1. **Connect Receiver to Terminal Block**
Connect the BROWN/BLUE/EARTH plug from the terminal block to the AC power input connection on the receiver. Connect the YELLOW/GREEN earth wire from terminal block to the YELLOW/GREEN earth wire connection from the fan.
2. **Connect Receiver to Motor**
Connect the motor wire coming from the fan (GREY/YELLOW/WHITE wires) to the 3-pin connection on the receiver
3. **Connect receiver to Light**
Connect the light wire plug coming from fan (ORANGE/BLUE) to the 2 pin connection on the receiver.

6. Install the Ceiling Canopy and Trim Ring

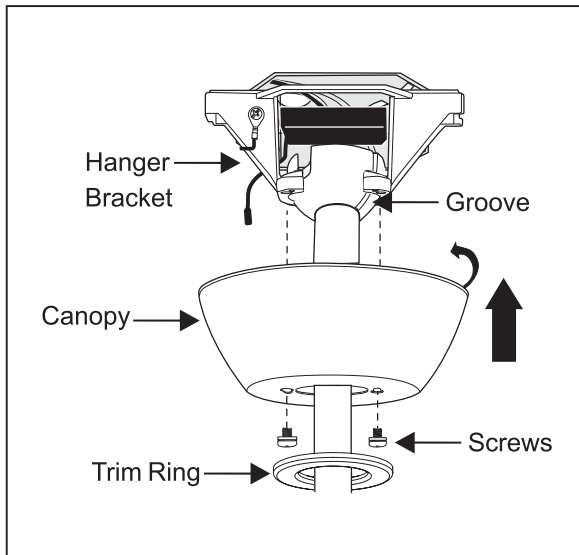

1. Lift the ceiling canopy up and over the hanger bracket, lining the key slot in the ceiling canopy over the remaining shoulder screw in the hanger bracket. Rotate the ceiling canopy to lock around the shoulder screws and then tighten the shoulder screw.
2. Lift the canopy trim ring over the screws and center accordingly.. The trim ring will be engaged and held by magnet.

7. Install light kit or bottom cover

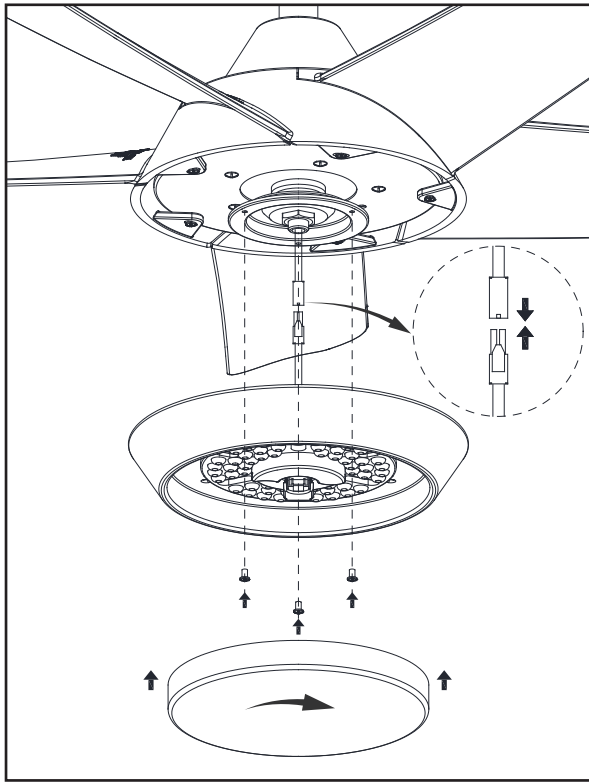

For fan with light kit.

Connect the light wire plug from the motor to the light wire plug from the LED light kit.

Use the 3 x screws to attach the LED light kit to the bottom of the fan motor.

Attach the LED lamp shade to the LED light kit by twisting anti-clockwise into place.

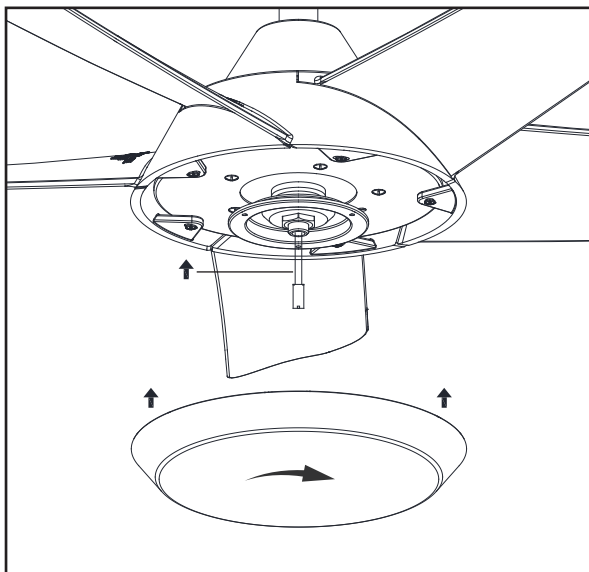

For fan without light kit.

Please gently to push the light wires into central shaft of motor when the fan doesn't use light kit

Carefully lift the bottom cover plate and attach to the bottom of the fan motor by twisting anti-clockwise to lock into place.

8. Operating the handset (transmitter)

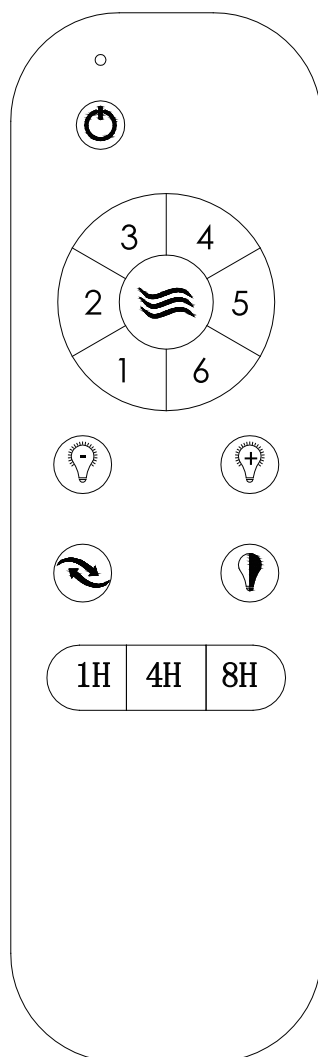

Fan Speed: Press and release immediately to turn on and set fan speeds. Number 6 is the highest speed and Number 1 is the lowest.



Fan Off: Press to turn the fan off.



Natural Wind Mode: Fan speed changes within its range creating a gentle sea-breeze effect.



Press and hold this button to increase the LED light – stop holding the button when desired brightness achieved.



Press and hold this button to decrease the LED light – stop holding the button when desired brightness achieved.



ON/OFF-Turn the light On/Off by pressing this button.

CCT- Change the LED colour temperature by turning the light ON and then rapidly OFF then ON within 2 seconds. This will rotate through the available colour temperatures.



Fan Reverse: Press to change the direction of your ceiling fan. It will slow and then change directions.

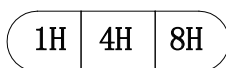

To use the timer, first select the function required, for example fan on speed 3 and light on. Then press the required timer button. The fan and light will switch off after the selected period of time

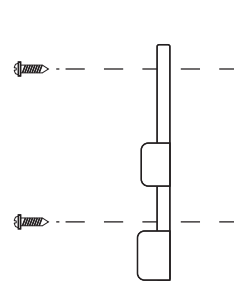
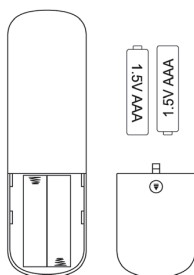

Learning/Pairing Setup

The handset and remote control receiver module are pre-programmed at the factory and do not normally require pairing.

IMPORTANT - When setting up multiple ceiling fans with a remote system, each fan in turn needs to be powered up, coded using the steps below, and then **DISCONNECTED** from the power supply **BEFORE** moving on to the next fan

1. Ensure that AC Power is isolated (switched off) to the ceiling fan.
2. Restore AC power to the fan. Within 30 seconds **PRESS** and **HOLD** the Fan Power button for 5 seconds.
3. The remote control receiver will beep twice to indicate the pairing was successful.

Blade balancing

Whilst every precaution is taken at the factory to ensure your fan is of the highest quality, imbalance may occur. This may be due to slight irregularities in the blades or blade carriers. Further problems can be caused by deviating from these instructions.

The following procedure may help to rectify the situation.

The hanger bracket must always be tight against the ceiling so that no movement can occur.

Make sure that the rod is firmly locked into the boss on top of the fan. The locking screw should be securely tightened.

Check all the blades are firmly tightened onto motor

Blade tracking can easily be checked by holding a yardstick or similar measure vertically from the ceiling to the tip of the blade. Then check all blades measure the same distance from that point. To correct slight problems in the alignment of a blade, gently bend the carrier to bring it back in line.

Changing over two adjacent blades – may correct any imbalance.

Please note that drop rod styles of fans do have a slight level of movement but this is in no way dangerous

Care and cleaning

Ensure that periodic checks of the fixings takes place. (see Safety Precaution 9)

Periodic cleaning of your new Fantasia fan is recommended particularly the blades. The plated or painted surfaces of your fan have been sealed with a lacquer to minimize any discoloration or tarnishing. Therefore use a soft brush or lint free cloth to avoid scratching the surface.

The motor has permanently sealed bearings so no lubrication is necessary

Do not use water when cleaning your fan as this could damage the surfaces of the casing and the blades and may create the possibility of an electric shock.

Product Disposal Instructions



This product has been classed as Electrical or Electronic Equipment and should not be disposed of with other household or commercial waste at the end of its working life.

The Waste of Electrical and Electronic Equipment (WEEE) Directive (2002/96/EC) has been put in place to recycle products using best available practice and minimize the impact upon the environment.

Ceiling Fan Warranty.

You must have the original purchase receipt or bill of sale to make a warranty claim. No claim will be accepted unless proof of date of purchase is available at the time of making the warranty claim.

Ceiling Fan Warranty Period.

The ceiling fan itself, excluding accessories such as the Remote Control Transmitter and Receiver, is covered by a 10 year warranty. During this period, Fantasia Distribution Ltd will, at its discretion, repair or replace defective product. During this 10 years, the owner is responsible for labour costs incurred in removing and re-installing the fan, and for transport costs to Fantasia Distribution Ltd's repair centre. Return freight will be paid by Fantasia Distribution Ltd. The cost of obtaining or using special access equipment (scissor lifts, scaffolding etc.) is specifically excluded, and it is the responsibility of the owner to provide such equipment and have it safely installed and operated.

Remote Control and LED Array Warranty Period.

Fantasia Distribution Ltd's LED Array Remote Control Receivers and Transmitters (Handsets) are covered by a 2 year repair or replacement warranty

Balance of Warranty on Repaired or Replaced Products.

Any replaced or repaired product is covered only by the balance of the warranty remaining on the original article.

Transfer of Warranty.

If the dwelling where the fan or remote control is installed changes hands, the balance of the warranty passes to the new owner, providing the original bill of sale for the product is retained by the new owner.

Warranty for the fan does not cover damage to the fan if it is moved from one dwelling to another during the warranty period. The warranty is voided in total if the product is sold as second hand goods.

The following is NOT covered by warranty.

1. Any damage incurred after delivery to the owner that is not caused by a fault in the products materials or workmanship; damage from lightning or power surges; incorrect installation; damage due to incorrect installation; water damage of any kind; installation or use outdoors; damage arising from connection to or use with alternative power systems (e.g. inverters, solar, etc.).
2. Ceiling fans not installed by a qualified electrician.
3. Repair of a ceiling fan used incorrectly, accidentally damaged, modified in any way or not serviced in accordance with the maintenance instructions.
4. The cost of transporting and insuring the ceiling fan between the nearest Fantasia Distribution Ltd agents' service depot and its normal location.
These costs must be met by the purchaser
5. Subject to any statutory provisions to the contrary, claims for damage to furniture, carpet, walls, ceilings, foundations or any other consequential loss either directly or indirectly resulting from a faulty ceiling fan.
6. Fantasia Ceiling Fans not purchased and installed in Mainland UK.
7. A service fee will be charged where; there is nothing wrong with the ceiling fan or; the defective operation of the ceiling fan is due to failure of electricity or; the installation is not in accordance with Fantasia Distribution Ltd instructions and/or applicable local regulations or; the defects have been caused by incorrect application or abuse of the ceiling fan or; the damage has been caused by unauthorised persons attempting to repair the fan.

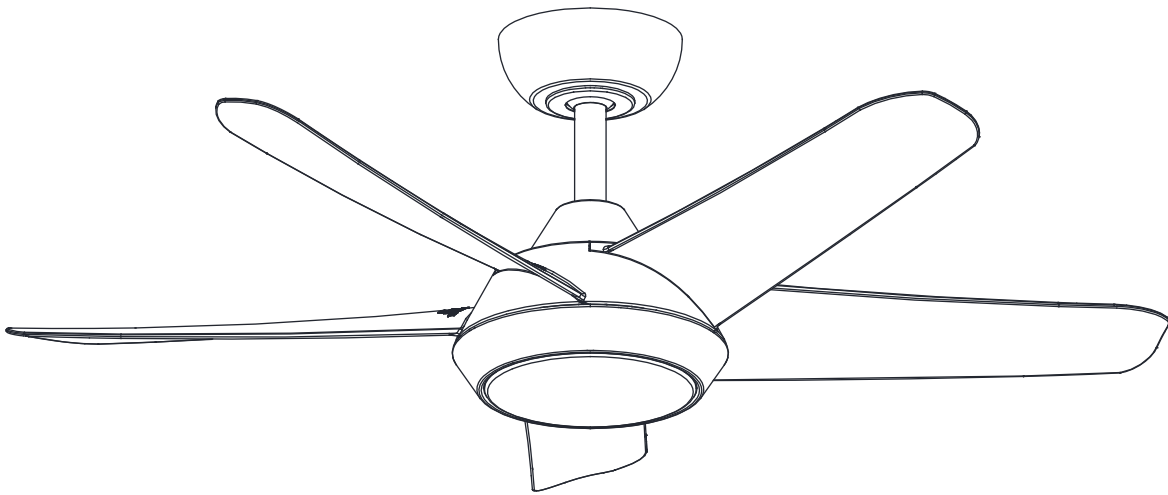

102cm/40"

Stellar

FANTASIA DISTRIBUTION LTD.

Britannia House, Unit 11 Faraday Way, Orpington, BR5 3QW

Tel : (01959) 564 440 Fax : (01959) 564 829

E-MAIL: info@fantasiaceilingfans.com

Fantasia ceiling fans - Warranty Activation Form

To activate your warranty please complete this form, and post it back to us at Fantasia

Name.....

Address.....

Town.....

Post Code.....

Email.....

Purchased from.....

Date Installed.....

Please tick this box if you would like to receive updates on:

The Fantasia Elite Range ☐

The Fantasia Standard Range ☐

1. How did you first hear about Fantasia Ceiling Fans?

Shop Display ☐

Brochure ☐

Friend's Recommendation ☐

Web Search ☐

Other.....

2. In which room is your fan installed?

.....

3. What do you think would be a good name for a ceiling fan?

.....

*£50 to the owner of any suggestions used!

4. Do you consider a ceiling fan to be a good alternative to air conditioning?

Yes ☐

No ☐

5. Do you intend to use the reverse function of your ceiling fan in Winter?

Yes ☐

No ☐

6. What do you like most about Fantasia Ceiling Fans?

.....

Thank you for answering these questions.
Your answers will help us excel in customer service and product development

I have read the terms of the warranty and agree to adhere to them

Print.....

Signed.....

Date.....



102cm/40"

Stellar

Please cut out this warranty page and send it in an envelope to the address below.

Alternatively please go to our website www.fantasiaceilingfans.com and fill in the warranty section there.

FANTASIA DISTRIBUTION LTD.
Britannia House, Unit 11 Faraday Way, Orpington, BR5 3QW
Tel : (01959) 564 440 Fax : (01959) 564 829
E-MAIL: info@fantasiaceilingfans.com